

I . SCOPE :

This specification applies to the Pb Free high current type SMD inductors for
MSCDRI-127ASH0-SERIES-□

PRODUCT IDENTIFICATION

MSCDRI - 127AS H0 - 100 M - □

① ② ③ ④ ⑤ ⑥

- ① Product Code
- ② Dimensions Code
- ③ AEC-Q200 Code
- ④ Inductance Code
- ⑤ Tolerance Code
- ⑥ Inner Control Code

(1) SHAPES AND DIMENSIONS

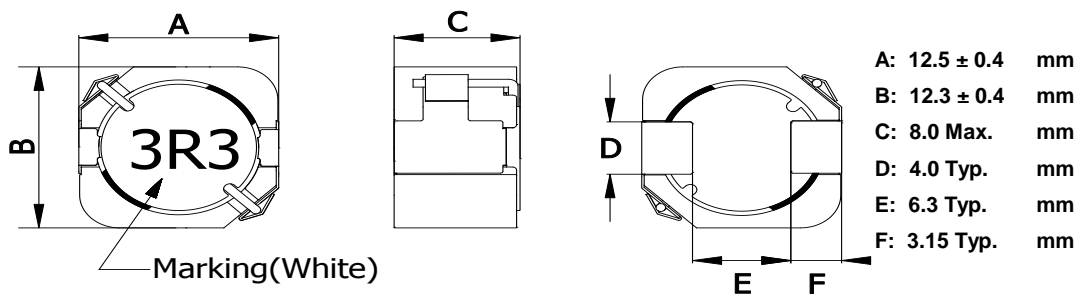

(2) ELECTRICAL SPECIFICATIONS

SEE TABLE 1

TEST INSTRUMENTS

L : HP 4284A PRECISION LCR METER (or equivalent)
RDC : CHROMA MODEL 16502 MILLIOHMMETER (or equivalent)

(3) CHARACTERISTICS

(3)-1 Operate temperature range $-50^{\circ}\text{C} \sim +150^{\circ}\text{C}$
(Including self temp. rise)

Note: On customer side this product series need to be fixed by the glue after IR reflow.
Please refer to below example photo:



Glue

TABLE 1

MAGLAYERS PT/NO.	Inductance L(μH)	Percent Tolerance	Resistance RDC(Ω)	Q Min.	Rated DC Current			Marking
					Isat1(A)	Isat2(A)	Irms(A)	
MSCDRI-127ASH0-1R5□-F	1.5	N	5.5m ±30%	-	-	23.5	10.50	1R5
MSCDRI-127ASH0-2R2□-F	2.2	N	6.3m ±30%	-	-	20.0	9.70	2R2
MSCDRI-127ASH0-3R3□-E	3.3	N	10m Max.	-	-	13.5	9.60	3R3
MSCDRI-127ASH0-4R7□-E	4.7	M,N	18m Max.	-	7.60	-	6.50	4R7
MSCDRI-127ASH0-6R8□-E	6.8	M,N	15m Max.	-	-	9.85	6.60	6R8
MSCDRI-127ASH0-100□-E	10	M,N	12m ±20%	14	-	8.00	7.70	100
MSCDRI-127ASH0-100□-F	10	M,N	12m ±20%	14	-	9.20	7.70	100
MSCDRI-127ASH0-150□-F	15	M,N	24m ±20%	-	-	7.40	5.10	150
MSCDRI-127ASH0-220□-F	22	M,N	27m ±20%	-	-	5.80	4.50	220
MSCDRI-127ASH0-470□-F	47	M,N	66m ±20%	-	-	4.20	3.20	470
MSCDRI-127ASH0-680□-F	68	M,N	90m ±20%	-	-	3.60	2.70	680
MSCDRI-127ASH0-101□-F	100	M,N	0.11 ±20%	-	-	2.90	2.60	101
MSCDRI-127ASH0-101□-H	100	M,N	0.115 ±30%	-	-	3.05	2.80	101
MSCDRI-127ASH0-221□-F	220	M,N	0.28 ±20%	-	-	1.95	1.60	221

※ Test Frequency:100KHz/0.25V

※ □ specify the inductance tolerance,M(±20%),N(±30%)

※ Isat1 : Based on inductance change ($\Delta L/L_0$: drop 30% Max.) @ambient temperature 25℃

Isat2 : Based on inductance change ($\Delta L/L_0$: drop 30% Typ.) @ambient temperature 25℃

Irms : Based on temperature rise (ΔT : 40℃ Typ.)



MAG.LAYERS

(4) LAND DIMENSION (Ref.)

PCB: GLASS EPOXY $t=1.6\text{mm}$

(4)-1 LAND PATTERN DIMENSIONS

(STANDARD PATTERN)

Unit:mm

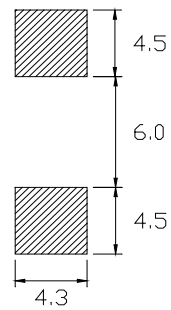

(4)-2 SUBSTRATE BENDING TEST BENDING TEST BOARD

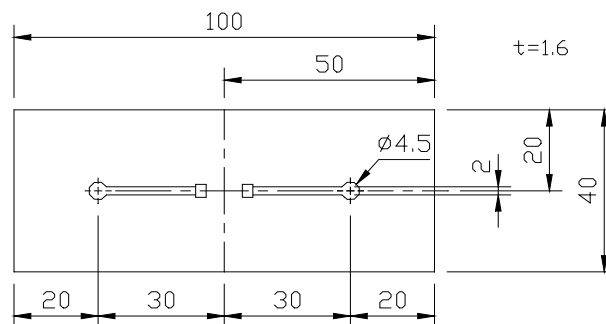

MAG.LAYERS

(5) PACKAGING
(5)-1 CARRIER TAPE DIMENSIONS (mm)

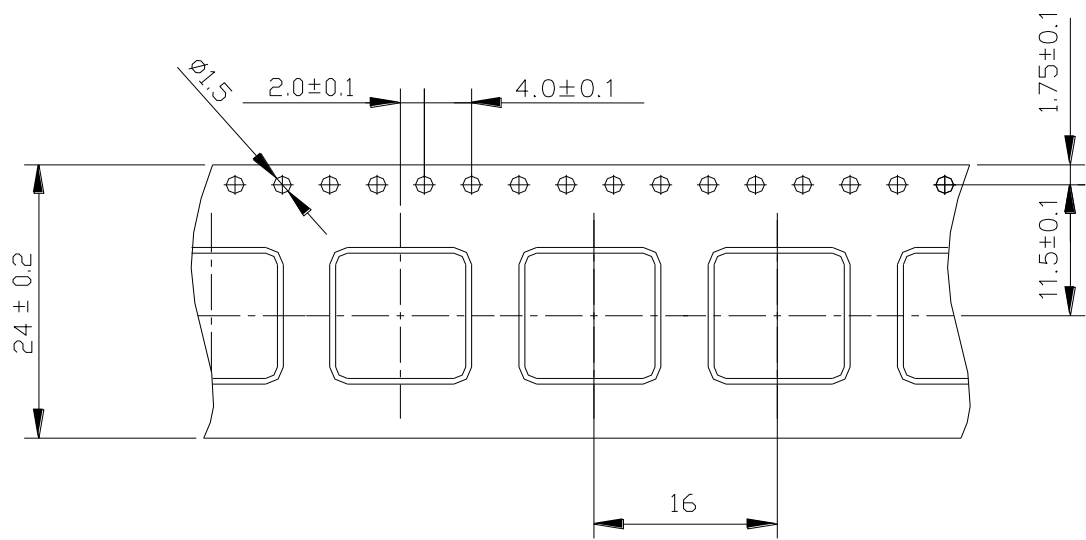

(5)-2 TAPING DIMENSIONS (mm)

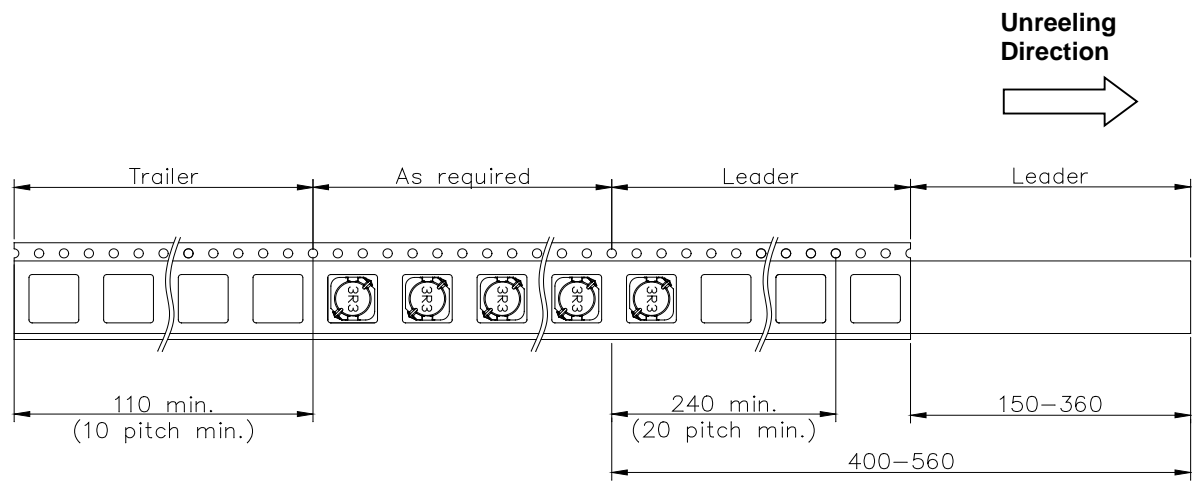

(5)-3 REEL DIMENSIONS (mm)

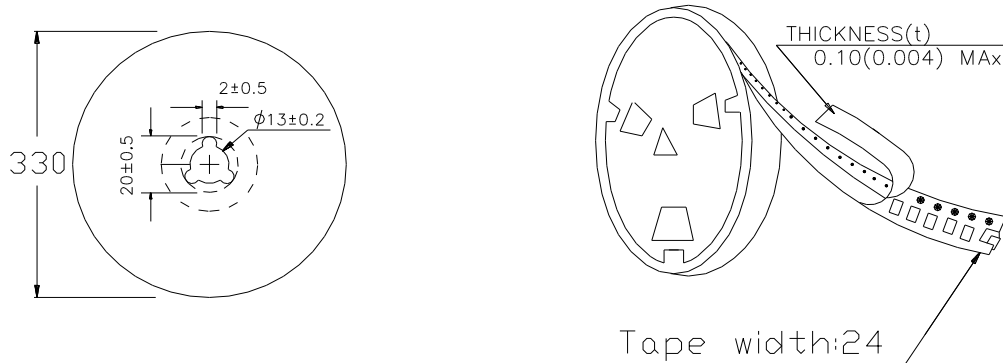

(5)-4 QUANTITY

400 pcs/Reel

The products are packaged so that no damage will be sustained.

Please note that the contents may change without any prior notice due to reasons such as upgrading.